



To arrange a viewing
please call 01908 675747

*** Recently Renovated *** This beautifully presented property located in Bletchley offers THREE BEDROOMS and a NEWLY INSTALLED KITCHEN WITH A NEW BOILER. The property also benefits from off road parking located behind the property and a single garage. Perfect for anyone looking for something that requires no work doing. Also a new roof has been installed to further add to the properties benefits.

*** Enquire Now Not To Miss Out ***

- Recently Renovated Throughout
- Three Bedrooms
- Brand New Boiler
- Brand New Kitchen
- New Front & Back Doors
- Single Garage
- Easy Access To Train Station

LOCATION: BLETCHLEY

Bletchley is an independent town lying to the South of Milton Keynes offering a wide variety of shops, mainly located on the High Street. Schools in the area include Abbays Primary School, Leon Secondary and Lord Grey Secondary School. There is also a main college in Bletchley.

Ground Floor

Entrance Hall

Lounge/Diner

22'9" x 12'0"

Kitchen

10'5" x 8'10"

First Floor

Landing

Bedroom 1

12'4" x 9'0"

Bedroom 2

11'1" x 6'6"

Bedroom 3

8'7" x 7'10"

Bathroom

6'4" x 5'5"

Single Garage

Notice:

Please note that we have not tested any internal fixtures or carried out any structural surveys. We advise all buyer to check all aspects of the property and although the details above have been described to the best of our abilities we would advise any buyer to carry out their own checks and to check with their independent legal representative to confirm any of the above details.



To arrange a viewing
please call 01908 675747



To arrange a viewing
please call 01908 675747







To arrange a viewing
please call 01908 675747

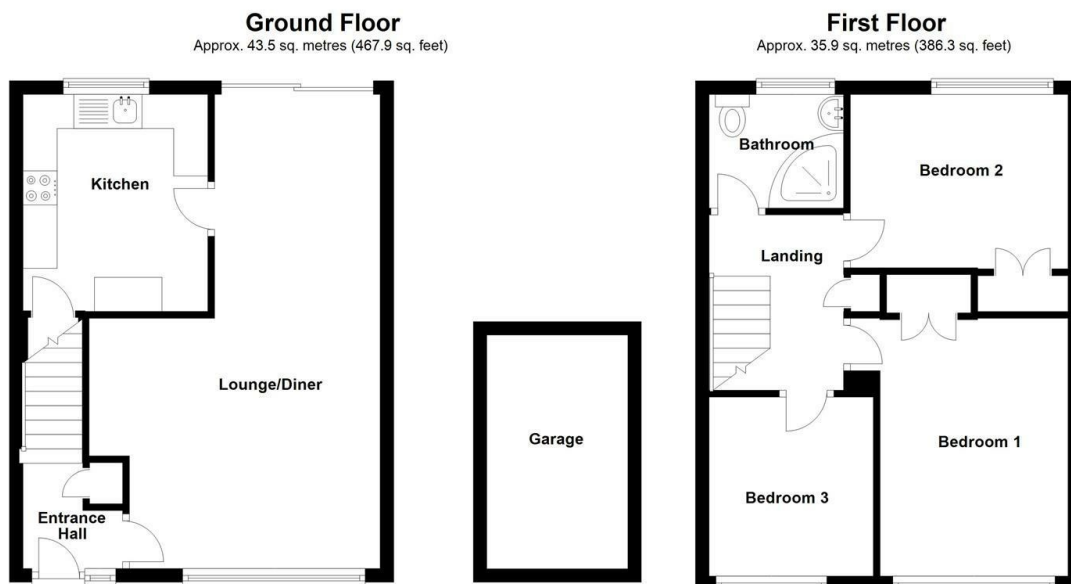

Total area: approx. 79.4 sq. metres (854.2 sq. feet)

This floorplan has been created and is owned solely by Alan Francis Estate Agents
Plan produced using PlanUp.

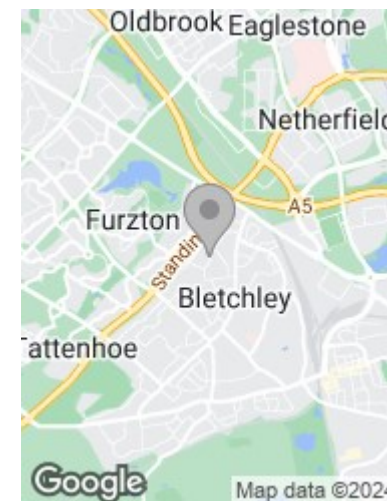

Energy Efficiency Rating		
	Current	Potential
Very energy efficient - lower running costs		
(92 plus) A		89
(81-91) B		
(69-80) C	70	
(55-68) D		
(39-54) E		
(21-38) F		
(1-20) G		
Not energy efficient - higher running costs		
England & Wales		EU Directive 2002/91/EC

Draft Details

These details have been submitted to our clients but at the moment have not been approved by them. We therefore, cannot guarantee their accuracy and they are distributed on this basis. Please ensure you have a copy of our approved details before committing yourself to any expense.

Whilst we endeavour to make our sales details accurate and reliable, if there is any point which is of particular importance to you, please contact the office and we shall be pleased to check any information for you. Do so, especially if travelling any distance to view the property.

The mention of any appliances and/or services within these details does not imply they are in full and efficient working order.

Any plans included within these details are a GUIDE TO THE LAYOUT OF THE PROPERTY ONLY and are NOT DRAWN TO SCALE. Dimensions are approximate.

Mortgage Information

We can offer independent mortgage advice. Please call us to discuss your requirements. Your home may be repossessed if you do not keep up repayment on your mortgage or any loans secured on it.

Property Valuations

We have some of the most experienced property valuers in Milton Keynes and would welcome the opportunity to carry out a VALUATION and MARKET APPRAISAL of your home.

Viewing Arrangements

Please call us to make an appointment to view this property.

Monday to Friday 9.00 am - 6.00 pm
Saturday 9.00 am - 4.00 pm
Sunday CLOSED

